

Install Guide for SloanLED VISTA

General Information

- SloanLED VISTA is dimming capable and can be installed to a dimming circuit.
- No serviceable parts are inside. Do not disassemble the fixture frame.
- Light source of luminaire is not replaceable; when light source reaches its end of life, whole luminaire shall be replaced.

FOR YOUR SAFETY

- Read and observe all NOTES, CAUTIONS, and WARNINGS shown throughout these instructions.
- Installation to be performed by licensed electrician.
- SloanLED VISTA is intended for indoor, dry, and damp locations only.
- Gloves and safety glasses or goggles should be worn while performing installation.
- Electrical specifications per luminaire:
100-277 VAC, 50/60 Hz (U.S.)
220-240 VAC, 50/60 Hz (EU)
- **WARNING** – Risk of fire or electric shock.
Disconnect branch power before installation.
- **WARNING** – To prevent wiring damage or abrasion, do not expose wiring to edges of sheet metal or other sharp objects.
- Knockouts are standard 1/2" (12.7 mm) Trade/Hub size.
- Ensure suitability of cable type and size per local code.
- Use UL approved strain reliefs suitable for application and per local code.
- Tighten strain relief per manufacturers specifications.
- Cap all unused wires.

Install Map

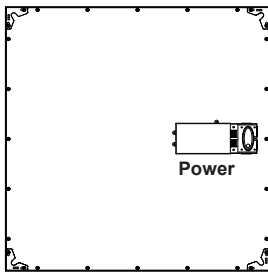

Part numbers:
FP10-1248-4040(X)
FP10-2424-4040(X)
FP10-2448-5040(X)



Part numbers:
FP10-6060-4040(X), FP10-6262-4040(X),
FP10-3012-4040(X), FP10-6012-5040(X)



Installation Instructions for all SloanLED VISTA part numbers.

Installation – Standard Ceiling Using Mounting Box

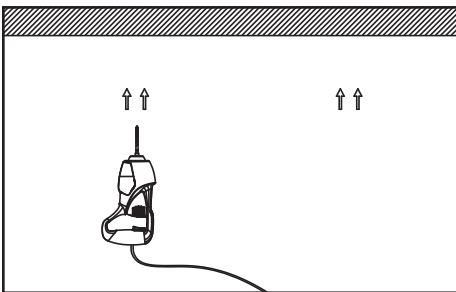

1. Prepare ceiling for steel cable installation by installing anchors into ceiling.

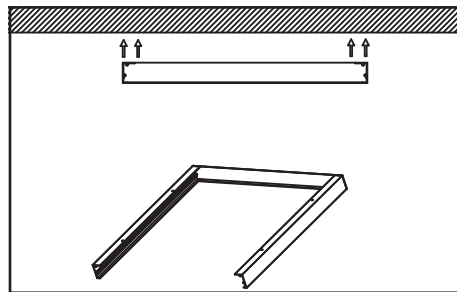

2. Install Mounting Box on ceiling.
NOTE: For part numbers FP10-6060-4040(X), FP10-6262-4040(X), FP10-3012-4040(X), and FP10-6012-5040(X), connect power supply and attach, according to local regulations, before proceeding to next step.

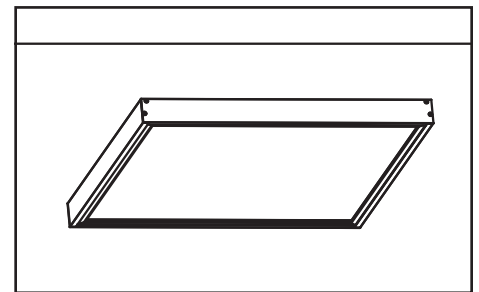

3. Push fixture into Mounting Box and secure.
Proceed to **Finishing Installation** section below.

Installation Instructions for part numbers FP10-2424-4040V, FP10-1248-4040V, and FP10-2448-5040V

Installation – T-Bar Ceiling Using Existing Steel Cables

WARNING! Risk of electrical shock. Turn off power to branch circuit at main breaker panel prior to installation. All primary wiring must be performed by a licensed electrician.

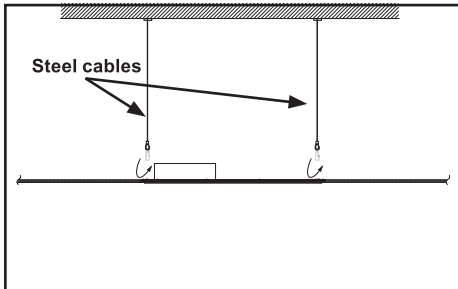

1. Ensure existing steel cables are secure, and align fixture with steel cables.

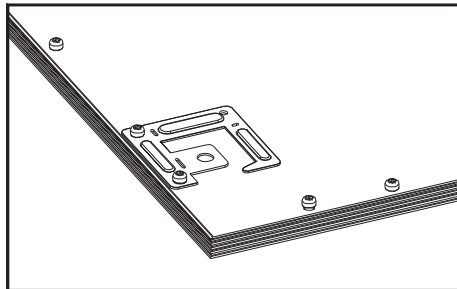

2. Bend metal tabs on back of fixture 90° to a standing position.

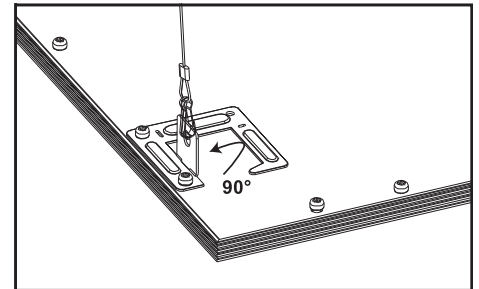

3. Secure all four metal tabs, on corners of fixture, to steel cables, and attach to ceiling structure per local code. Proceed to **Finishing Installation** section on page 4.

Installation – T-Bar Ceiling Using Built-in T-Bar Clips

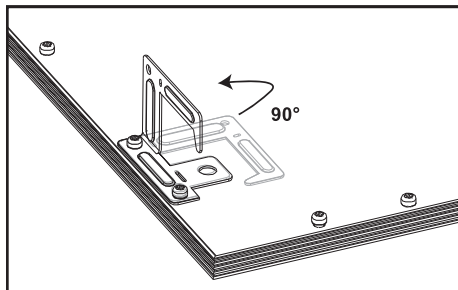

1. Bend metal tabs on back of fixture, 90° to form "L" hook.

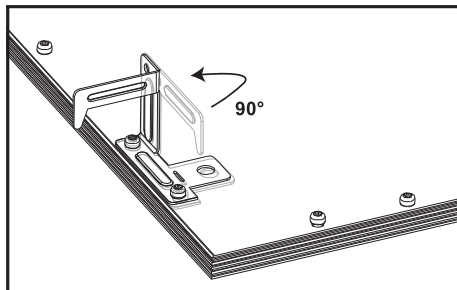

2. Insert fixture in T-Bar grid, and bend hook tabs over T-Bar to capture rails. Proceed to **Finishing Installation** section on page 4.

Installation – Mounting Using 4-Wire Suspension Kit (P/N: AXSUS-4W)

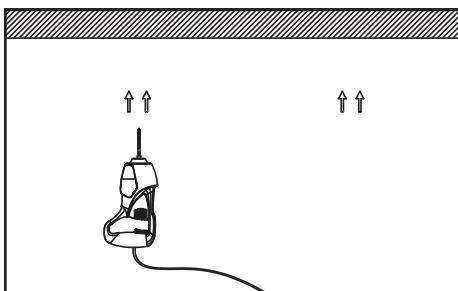

1. Prepare ceiling for steel cable installation by installing anchors into ceiling.

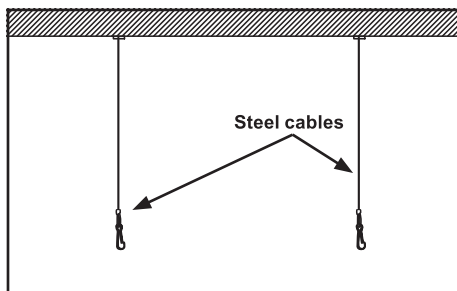

2. Install steel cables.

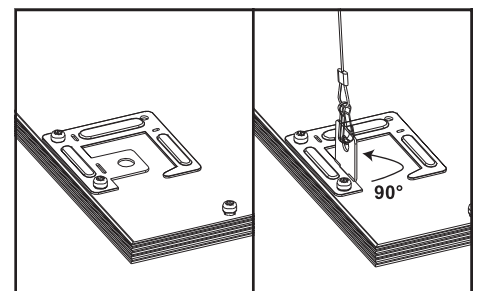

3. Bend metal tabs on back of fixture 90° to a standing position. Secure all four corners of fixture to steel cables with mounting clips, and attach to ceiling structure per local code. Proceed to **Finishing Installation** section on page 4.

Installation Instructions for part numbers FP10-6060-4040(X), FP10-6262-4040(X), FP10-3012-4040(X), and FP10-6012-5040(X)

Installation – T-Bar Ceiling Using Existing Steel Cables

WARNING! Risk of electrical shock. Turn off power to branch circuit at main breaker panel prior to installation. All primary wiring must be performed by a licensed electrician.

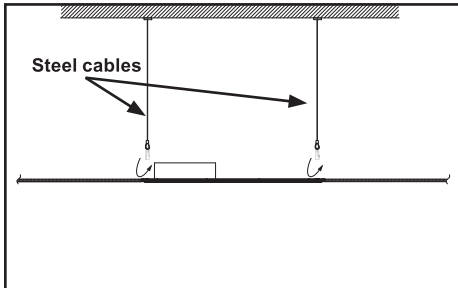

1. Ensure existing steel cables are secure, and align fixture with steel cables.

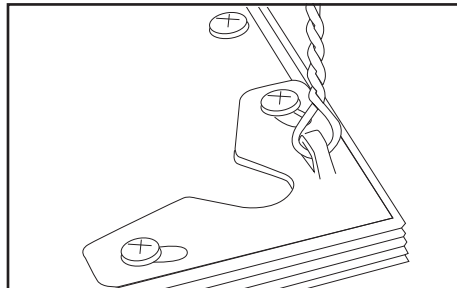

2. Secure all four corners of fixture to steel cables. Proceed to **Finishing Installation** section on page 4.

Installation – Mounting Using 4-Wire Suspension Kit (P/N: AXSUS-4W)

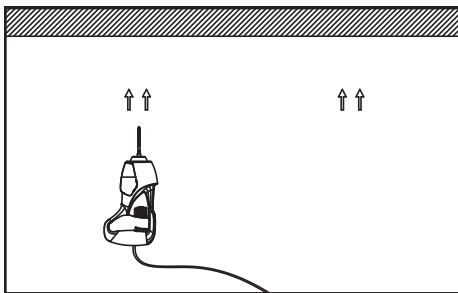

1. Prepare ceiling for steel cable installation by installing anchors into ceiling.

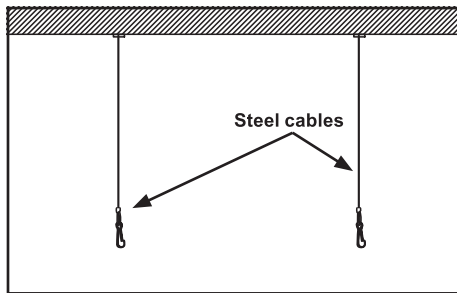

2. Install steel cables.
NOTE: For part numbers FP10-6060-4040(X), FP10-6262-4040(X), FP10-3012-4040(X), and FP10-6012-5040(X), connect power supply and attach, according to local regulations, before proceeding to next step.

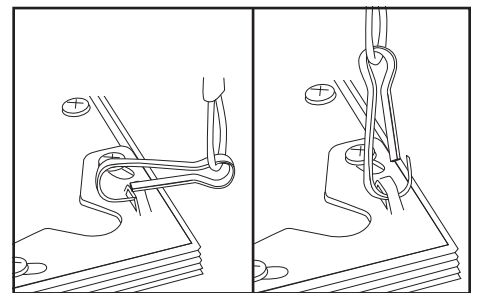

3. Secure all four corners of fixture to steel cables with mounting clips. Proceed to **Finishing Installation** section on page 4.

Finishing Installation

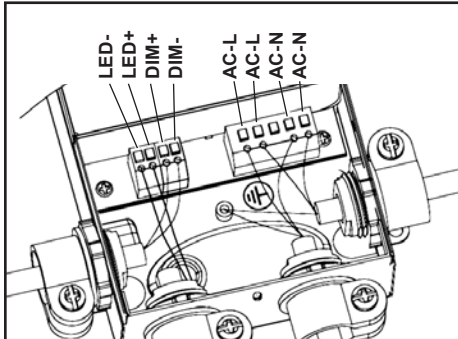

1. **To make primary electrical connections:**
Use UL listed quick disconnect or push in connectors according to your local electrical code.
 - a. Connect supply line from branch circuit to **AC-L** terminal.
 - b. Connect neutral line from branch circuit to **AC-N** terminal.
 - c. Connect grounding wire from branch circuit to grounding terminal.
- Return power to ON position and verify that light is functioning properly.

Dimming Wiring Instructions

1. Connect positive (+) side of dimming signal to DIM+ terminal.
2. Connect negative (-) side of dimming signal to DIM- terminal.
3. Verify dimming function after making primary power electrical connections.

0 - 10 V Dimming: Part numbers FP10-1248-4040V, FP10-2424-4040V, and FP10-2448-5040V

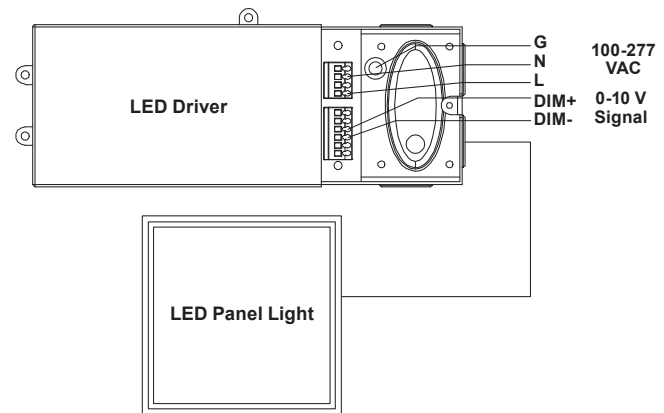

Fixed Operation: Part numbers FP10-6060-4040X, FP10-6262-4040X, FP10-3012-4040X, FP10-6012-5040X

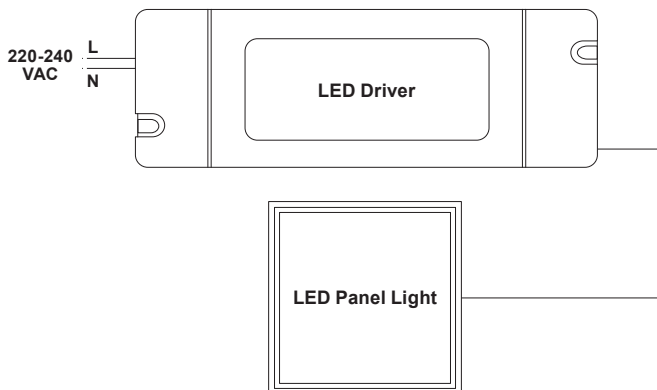

1-10 V Dimming: Part numbers FP10-6060-4040(V/A), FP10-6262-4040(V/A), FP10-3012-4040(V/A), FP10-6012-5040(V/A)

